

CITY OF BELMONT

Facilities for Hire

Middleton Park Community Centre & Reserve



Middleton Park Community Centre features a large multi-purpose room and reserve. While the multi-purpose room is primarily used by sporting clubs on weekends, it is available to hire for small functions and meetings during the week. It is adjacent to a sporting reserve that is used for cricket and football.

GENERAL INFORMATION	
Address	13 Middleton Street, Cloverdale (parking on Garvey Street)
Access Friendly	Yes, access friendly parking, ramps and toilets available
CCTV	Yes <i>(cameras will not be turned off for bookings and are not permitted to be obstructed at any time)</i>
Parking	Yes – street parking along Garvey Street and verge parking along Epsom Avenue
Wi-Fi	No
Equipment	Items such as TV's, projectors, audio/visual equipment and also cleaning equipment etc. are not provided and not available for hire through the City. Hirers have to supply all their own required equipment.
MULTI-PURPOSE ROOM	
Size	Approximately 10m x 7.5m (75sqm)
Max Capacity	50 people <i>(It is an offence under Health Act 1911 to exceed the maximum capacity stipulated on the certificate of approval)</i>
Floor	Vinyl
Chairs	50 <i>(measurements and photos available upon request)</i>
Tables	10 trestle tables - 1800mm x 750mm <i>(photos available upon request)</i>
Air Conditioning	Evaporative <i>(cooling only)</i>
Kitchen	Yes, included in hire is a small kitchen with a fridge/freezer, stove and oven, auto boiler urn, microwave and servery to room. Hirers are required to bring all their own plates/cutlery/cookware/cleaning equipment. The kitchen is to be used for warming up food purposes only. The kiosk roller door that serves outside is not available to hirers.
Toilets	Yes – this room has its own facilities (located in the passageway)

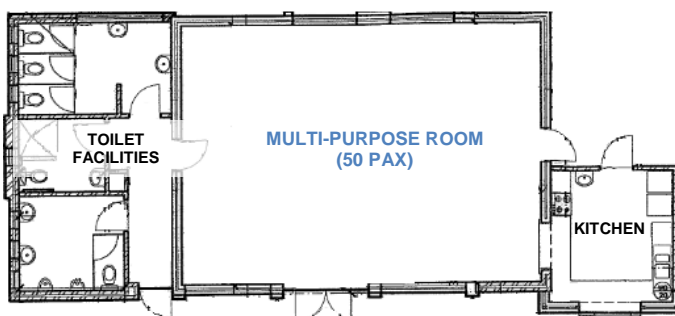

Areas Included in Hire



Multi-Purpose Room

RESERVE	
Sport Hire <i>(fees applicable)</i>	WINTER: Football – Line markings and goals in place 1 April – 30 Sept SUMMER: Cricket – two pitches and line marking in place 1 Oct – 30 March
Parking	Parking is available along Garvey Street and Epsom Avenue
Toilets	There are no public toilets available – toilets are available for use with hire of the reserve
Oval Lighting	There are two towers on this reserve for hire – fees are applicable and suitable for large ball sport only.
Changerooms	Yes – available for hire with reserve (toilets/showers).
Additional <i>(free to use)</i>	There are cricket practice nets available all year round. There is a small playground near the corner of Middleton Street & Sutherland Way.

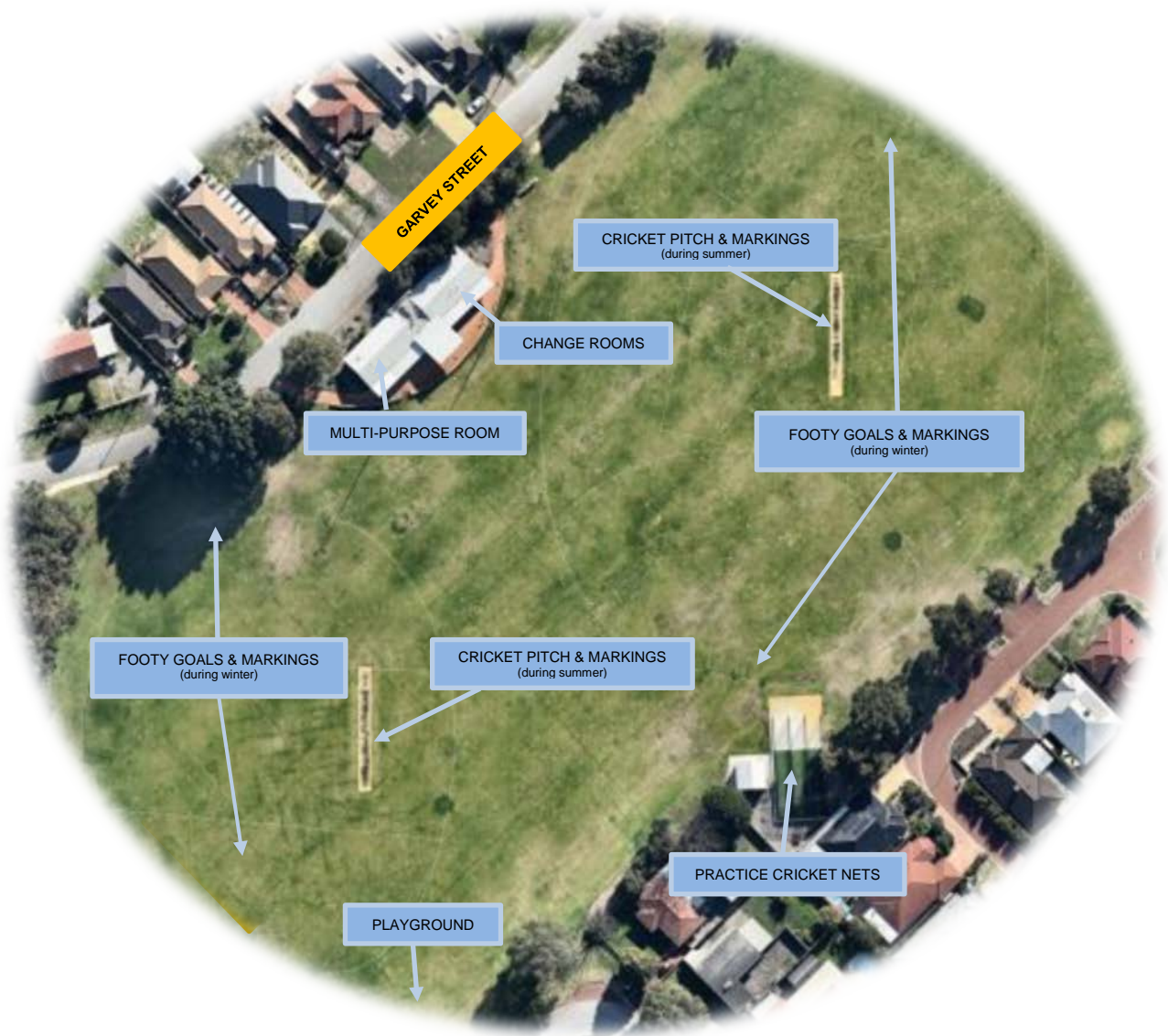

For further information and availability please contact venue.hire@belmont.wa.gov.au

