

CITY OF BELMONT Facilities for Hire

Redcliffe Community Centre & Reserve



Redcliffe Community Centre features a large main hall with a stage area, ideal for weddings, plays/productions, dance classes and large social functions. The multi-purpose room is primarily used by sporting clubs but due to the room having an enclosed play area attached it is ideal for smaller functions such as children's birthday parties. The center also has two small meeting rooms. Redcliffe Community Centre is adjacent to a sporting reserve that is primarily used for softball and social cricket.

GENERAL INFORMATION	
Address	33 Morgan Road, Redcliffe (main carpark comes off Grand Parade)
Access Friendly	Yes, access friendly parking, toilets and ramps available
CCTV	Yes (cameras will not be turned off for bookings and are not permitted to be obstructed at any time)
Parking	Yes – large carpark off Grand Parade (39 bays) and smaller carpark off Morgan Rd (8 bays)
Wi-Fi	No
Equipment	Items such as TV's, projectors, audio/visual equipment and also cleaning equipment etc. are not provided and not available for hire through the City. Hirers have to supply all their own required equipment.

ROOMS AVAILABLE FOR HIRE

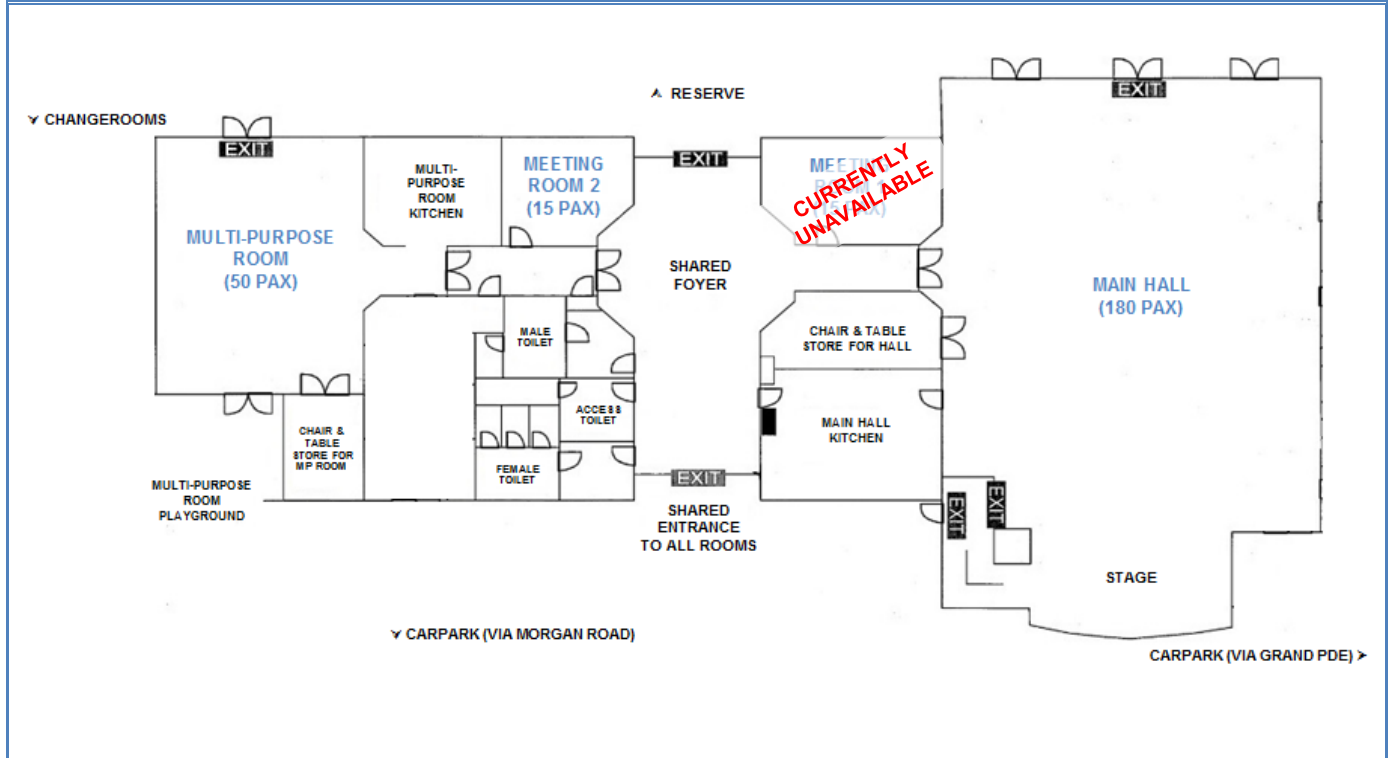

MAIN HALL	
Size	Approximately 13m x 18m (234sqm)
Max Capacity	180 people <i>(It is an offence under the Health Act 1911 to exceed the maximum capacity stipulated on the certificate of approval)</i>
Floor	Timber
Chairs	180 <i>(measurements and photos available upon request)</i>
Tables	25 trestle tables - 1800mm x 750mm <i>(photos available upon request)</i>
Air Conditioning	Evaporative <i>(cooling only)</i>
Kitchen	Yes, included in hire is a large kitchen with a fridge/freezer, large gas stove and electric oven, auto boiler urn, microwave and a servery into the hall. Hirers are required to bring all their own plates/cutlery/cookware/cleaning equipment. The kitchen is to be used for warming up food purposes only.
Toilets	Yes - shared facilities with the Multipurpose Room & Meeting Rooms (located in foyer)
Additional	<ul style="list-style-type: none"> Hall features a stage area with a manual fold out stage curtain <i>(stage roughly 6.8m wide x 3m deep)</i> There is a small pin board available for use during the time of hire There is an external door that leads into the backstage area

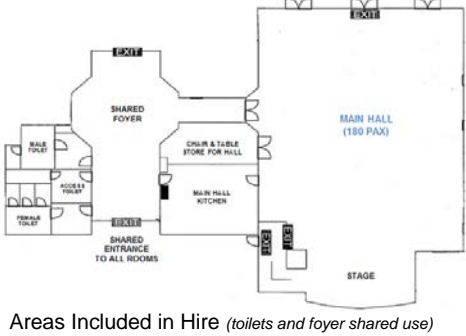

MEETING ROOM 1 – CURRENTLY UNAVAILABLE	
Size	Approximately 20sqm
Max Capacity	15 people <i>(It is an offence under the Health Act 1911 to exceed the maximum capacity stipulated on the certificate of approval)</i>
Floor	Carpet
Chairs	15 <i>(measurements and photos available upon request)</i>
Tables	3 trestle tables - 1800mm x 750mm <i>(photos available upon request)</i>
Air Conditioning	Evaporative <i>(cooling only)</i>
Kitchen	None included
Toilets	Yes - shared facilities with the Hall & Multipurpose Room <i>(located in foyer)</i>

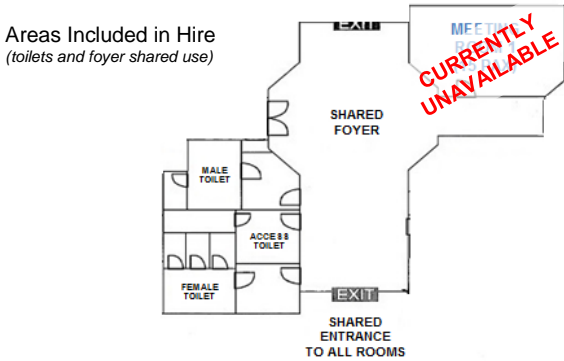

MULTI-PURPOSE ROOM	
Size	Approximately 9.5m x 7m (66sqm)
Max Capacity	50 people <i>(It is an offence under the Health Act 1911 to exceed the maximum capacity stipulated on the certificate of approval)</i>
Floor	Vinyl
Chairs	50 <i>(measurements and photos available upon request)</i>
Tables	7 trestle tables - 1800mm x 750mm <i>(photos available upon request)</i>
Air Conditioning	Split System <i>(heating & cooling)</i>
Kitchen	Yes, included in hire is a kitchen with a fridge/freezer, small gas stove and oven, auto boiler urn, microwave and a servery into the room. Hirers are required to bring all their own plates/cutlery/cookware/cleaning equipment. The kitchen is to be used for warming up food purposes only.
Toilets	Yes - shared facilities with the Hall & Meeting Rooms (located in foyer)
Additional	<ul style="list-style-type: none"> • Small enclosed play area (slide, sandpit etc.) under a shade sail • Pin boards available for use during the time of hire
Note	The kiosk roller door that serves outside is not available to casual hirers.

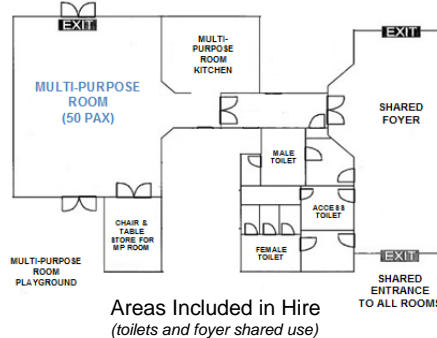

MEETING ROOM 2	
Size	Approximately 15sqm
Max Capacity	15 people <i>(It is an offence under the Health Act 1911 to exceed the maximum capacity stipulated on the certificate of approval)</i>
Floor	Carpet
Chairs	15 <i>(measurements and photos available upon request)</i>
Tables	3 trestle tables - 1800mm x 750mm <i>(photos available upon request)</i>
Air Conditioning	No – ceiling fan only
Kitchen	None included
Toilets	Yes - shared facilities with the Hall & Multipurpose Room <i>(located in foyer)</i>
Additional	Due to a window overlooking the foyer area this room is not very private

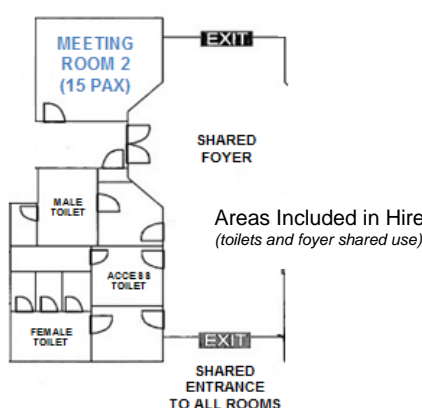

RESERVE/PARK AREA	
Sport Hire <i>(fees applicable)</i>	SUMMER: Tee-Ball & Softball – Line markings in place 1 Oct - 30 March ANNUAL: There is a cricket pitch here all year round (not available for night time hire)
Parking	Parking is available in the centre carpark and in the bays provided on Grand Parade
Toilets	No public toilets are located outside.
Oval Lighting	There are two light towers available – fees are applicable and suitable for large ball sport training only.
Changerooms	Yes – available for hire with reserve (toilets/showers)
Playgrounds	There is a free to use playground located near the Philomel Close end

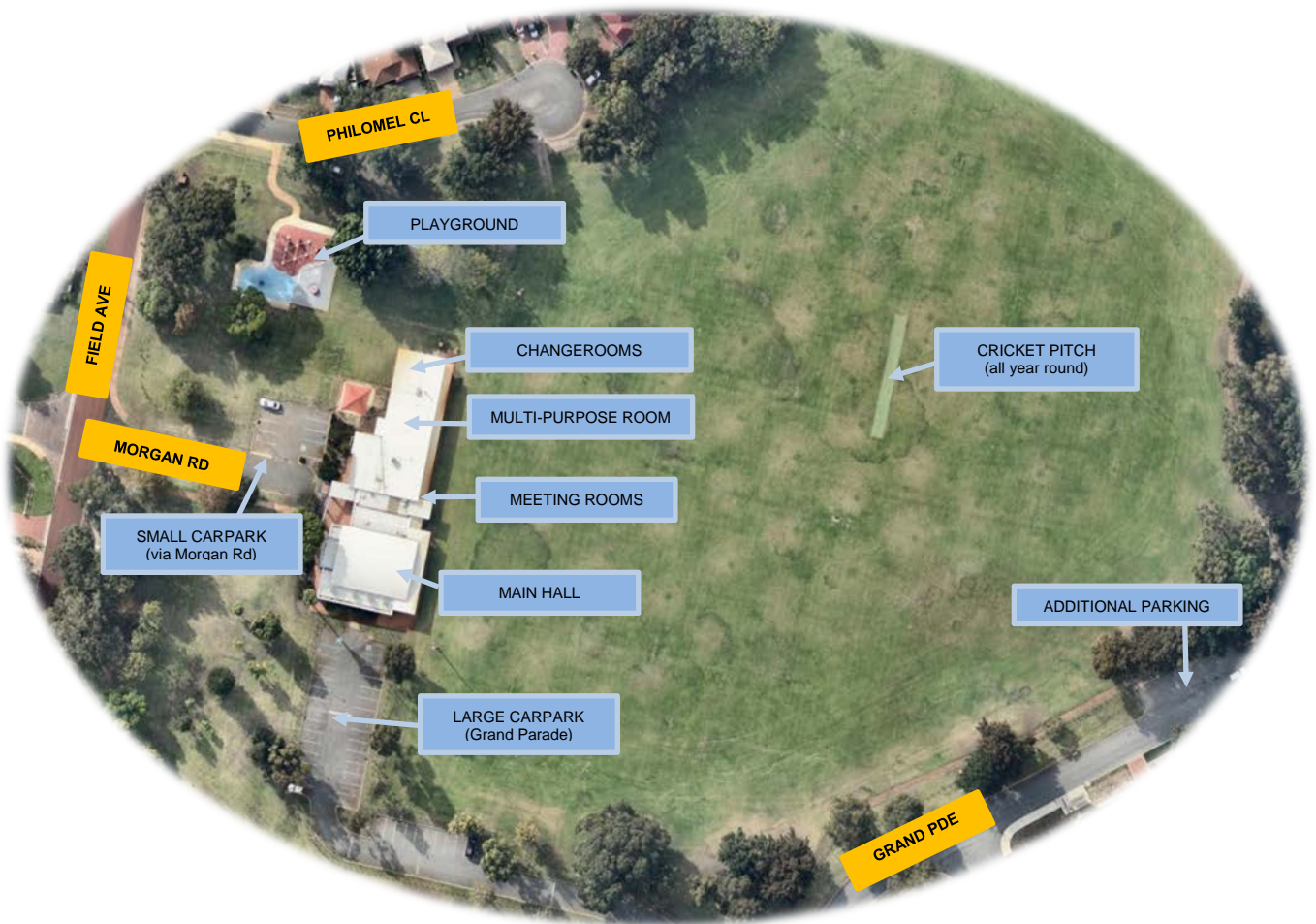

Video tours of this facility are available on the City's website
<http://www.belmont.wa.gov.au/Community/VenuesForHire>

For further information and availability please contact venue.hire@belmont.wa.gov.au

